

Sticker- installation instruction

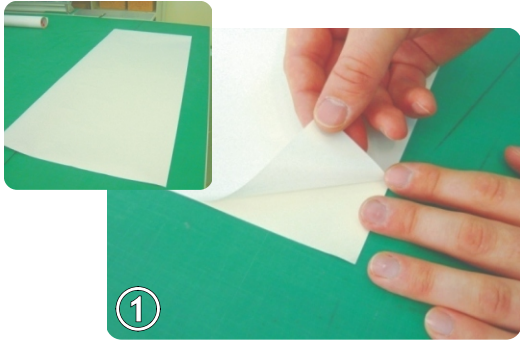

1. The glued side of the sticker is protected with silicon paper. When starting installation, both layers: printed vinyl and silicone paper have to be separated simultaneously starting at the top.



2. Peel of about 4 inches silicone paper only across the top of the panel. Do not peel off the entire layer all at once.

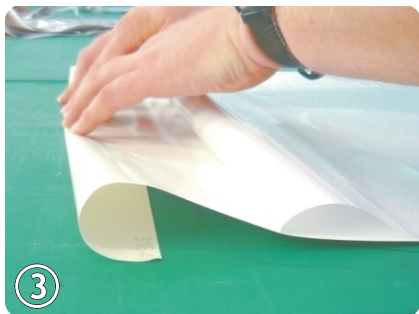

3. After separating of the vinyl and silicone fold gently about 4 inches of the silicone paper.



4. When completed step 3, you are ready to stick the sticker onto prepared surface.



5. While applying the sticker make sure you stick it on a smooth, dry surface. When you stick your sticker and you encounter something under the paper you can remove the sticker, and start again.

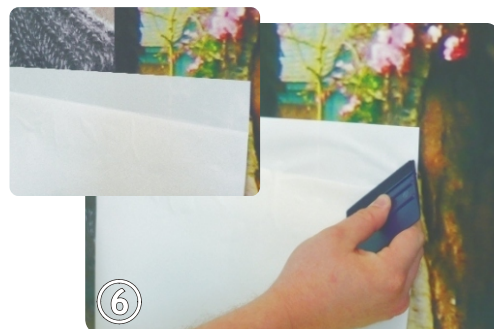

6. Once the first panel of your sticker is installed, you must gently rub it down with a squeegee or plastic smoother. Push out any air bubbles from the center outwards.



7. Once the first 4 inches are stick gently pull down the silicone paper by another 4 inches and repeat the previous steps.

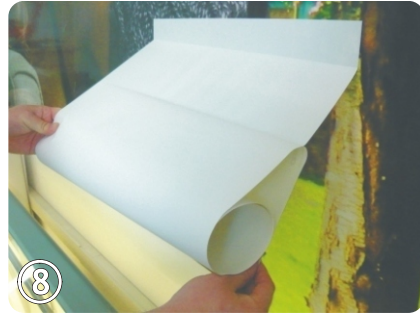

8. Once you have stick about 8 inches of the sticker, gently unroll the remained silicone layer.

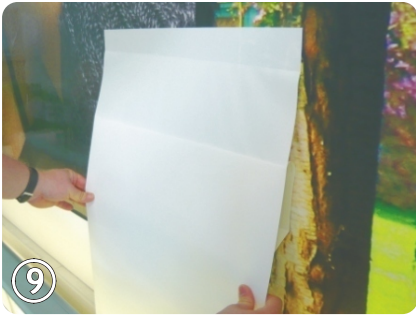

9. Pulling of the silicone paper only happens when the two papers are not separated yet.



10. Place your one hand firmly on the sticker before you start pulling the silicone paper from under the sticker, once in momentum take the hand of the sticker while with the other hand gently pulling the silicone paper down. Stickers should always be pulled from top to bottom. Avoid any air bubbles.

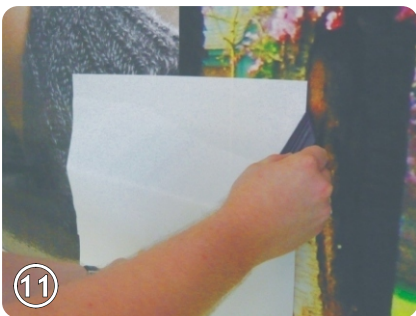

11. Your squeegee should be moved gently and evenly.

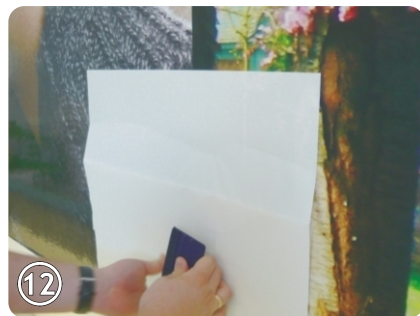

12. Please take into account that if the surface is not hard enough, sticking the stickers may damage it.